

CONCORD VILLA.

LAKE CITY, FLORIDA.

DESCRIPTION

ALL THOSE LANDS LYING AND BEING IN COLUMBIA COUNTY AND STATE OF FLORIDA MORE PARTICULARLY DESCRIBED AS FOLLOWS: THE EAST 1/2 OF THE NORTHWEST 1/4 - THE NORTHEAST 1/4 OF THE SOUTHWEST 1/4 - THE WEST 1/2 OF THE NORTHEAST 1/4 AND THE NORTHWEST 1/4 OF THE SOUTHEAST 1/4 OF SECTION 16, IN TOWNSHIP 4, SOUTH OF RANGE 17 EAST - TRACT CONTAINING 240 ACRES MORE OR LESS.

CERTIFICATION

THIS IS TO CERTIFY THAT THE ACCOMPANYING PLAT IS AN ACTUAL SURVEY OF THE LANDS DESCRIBED ABOVE AS MADE BY ME DURING THE MONTH OF APRIL 1925.

Geo. M. Smith ENGINEER

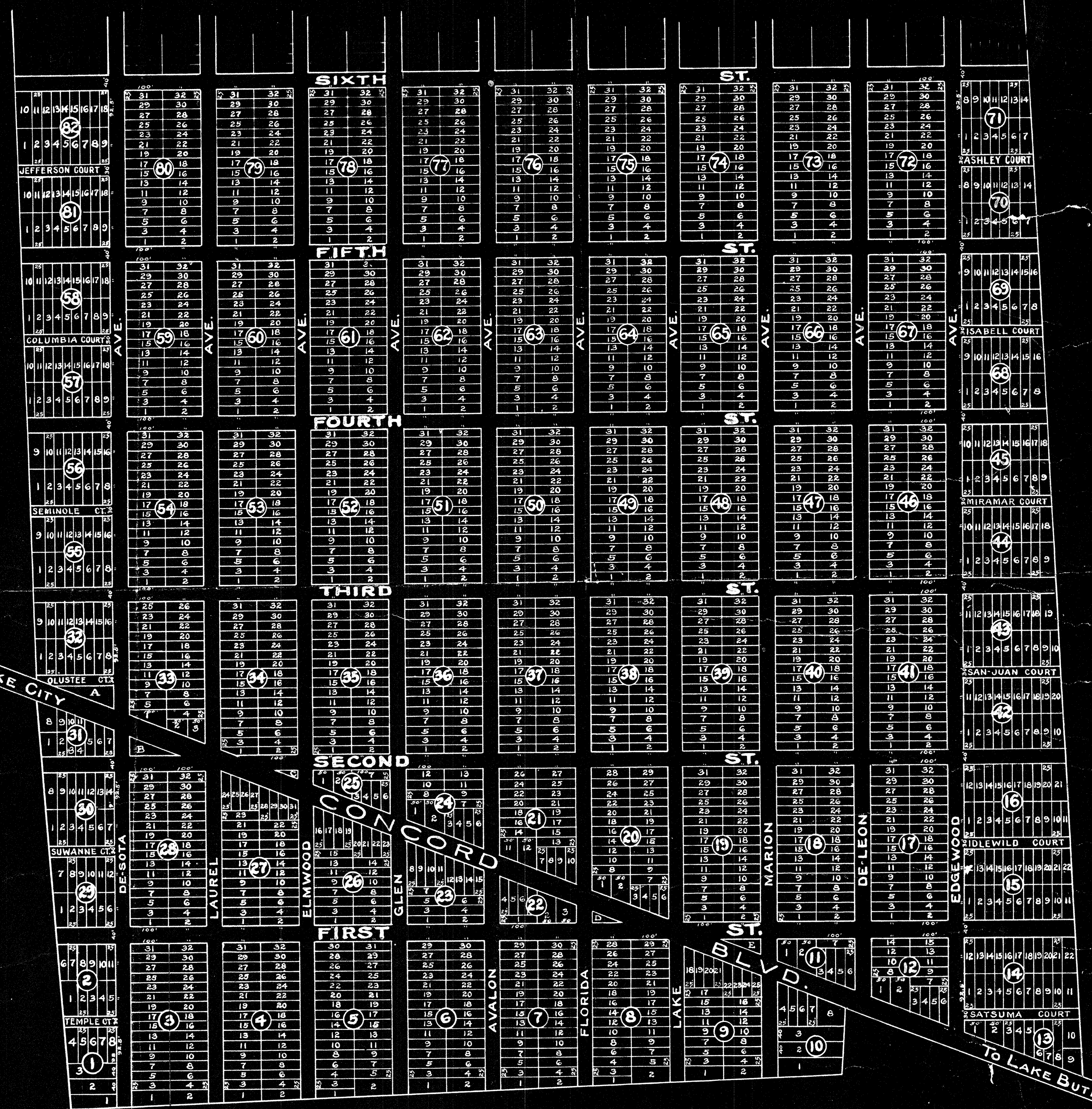

Scale - 1 in = 200 ft.

TO LAKE BUTLER

TO LAKE CITY

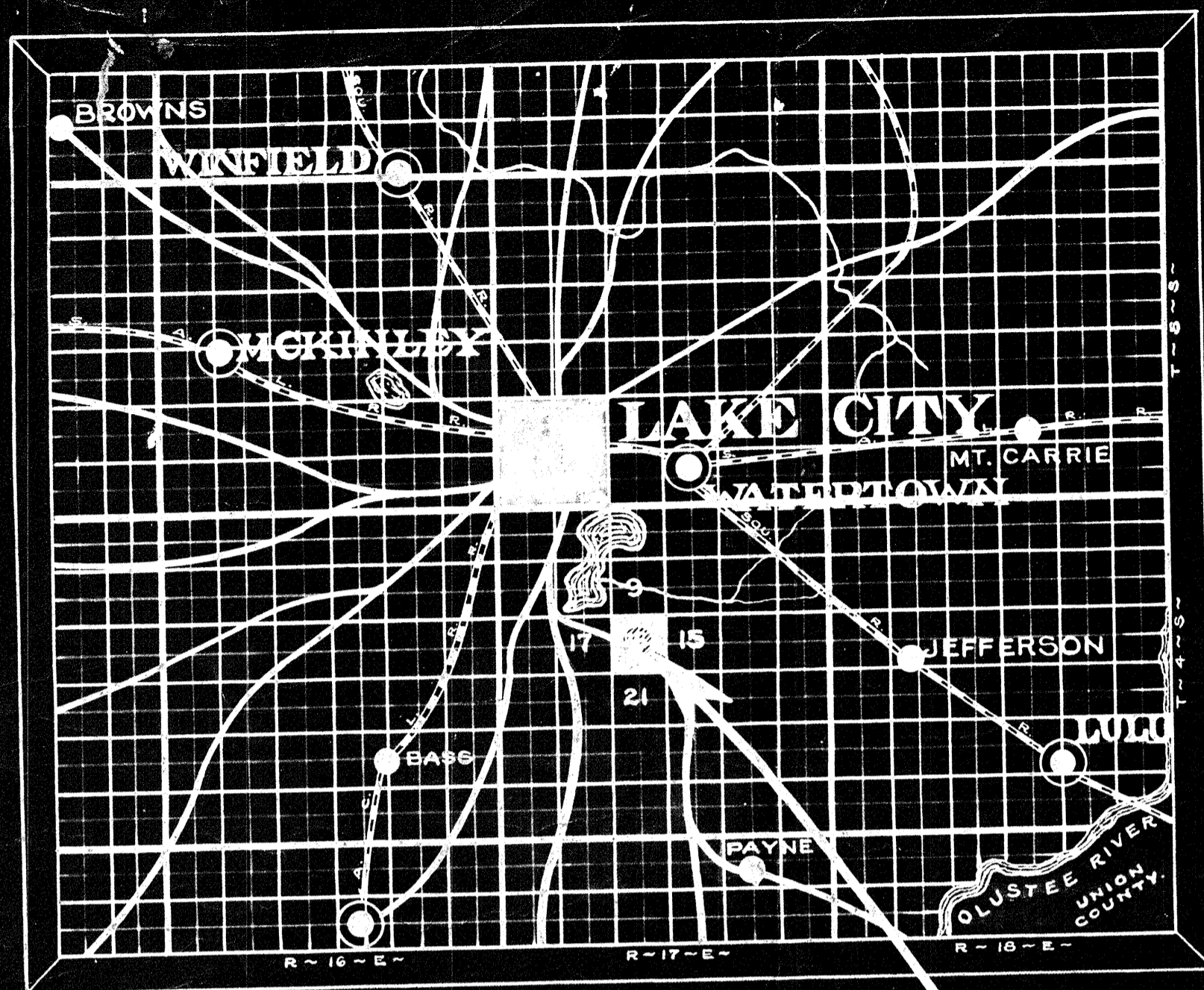

COLUMBIA COUNTY
SCALE OF MILES.
0 1 2 3 4 5

CONCORD VILLA.

LAKE CITY, FLORIDA.

DESCRIPTION

ALL THOSE LANDS LYING AND BEING IN COLUMBIA COUNTY AND STATE OF FLORIDA, MORE PARTICULARLY DESCRIBED AS FOLLOWS: THE EAST 1/2 OF THE NORTHWEST 1/4—THE NORTHEAST 1/4 OF THE SOUTHWEST 1/4—THE WEST 1/2 OF THE NORTHEAST 1/4 AND THE NORTHWEST 1/4 OF THE SOUTHEAST 1/4 OF SECTION 16, IN TOWNSHIP 4, SOUTH OF RANGE 17 EAST—TRACT CONTAINING 240 ACRES MORE OR LESS.

CERTIFICATION

THIS IS TO CERTIFY THAT THE ACCOMPANYING PLAT IS AN ACTUAL SURVEY OF THE LANDS DESCRIBED ABOVE AS MADE BY ME DURING THE MONTH OF APRIL 1925.

Geo. M. Smith ENGINEER



Scale - 1 in = 200 ft.