

"TIMBERLANDS PHASE 1"
 SECTIONS 10 & 15, TOWNSHIP 4 SOUTH, RANGE 16 EAST,
 COLUMBIA COUNTY, FLORIDA

PLAT BOOK **9**
 PAGES **26**
 SHEET 1 OF 2

DEDICATION:

KNOW ALL MEN BY THESE PRESENT THAT RML HOLDINGS, INC. AS OWNER, AND PEOPLES STATE BANK AS MORTGAGEE, HAVE CAUSED THE LANDS HEREON DESCRIBED, TO BE SURVEYED, SUBDIVIDED AND PLATTED, TO BE KNOWN AS "TIMBERLANDS PHASE 1", AND THAT ALL ROADS, STREETS, RETENTION AREAS, STORMWATER BASINS AND ALL EASEMENTS FOR UTILITIES, DRAINAGE, AND OTHER PURPOSES INCIDENT THERETO, AS SHOWN AND/OR DEPICTED HEREON ARE HEREBY DEDICATED FOR THE USE OF THE PUBLIC.

ATTESTS

Jody M. Coble
 WITNESS AS TO OWNER
Jody M. Coble
 WITNESS AS TO OWNER

Joel
 WITNESS AS TO OWNER
Joel
 WITNESS AS TO OWNER

Robert R. Lardizabal
 ROBERT R. LARDIZABAL,
 AS PRESIDENT OF RML HOLDINGS, INC.
Chris Dampier
 CHRIS DAMPIER
 AS SENIOR VICE-PRESIDENT

ACKNOWLEDGMENT: STATE OF FLORIDA, COUNTY OF COLUMBIA.

I HEREBY CERTIFY THAT ON THIS 8th DAY OF August, 2007 A.D., BEFORE ME PERSONALLY APPEARED ROBERT R. LARDIZABAL AS PRESIDENT OF RML HOLDINGS, INC., AS OWNER, TO ME KNOWN TO BE THE PERSON DESCRIBED IN AND WHO EXECUTED THE FORGOING DEDICATION AND ACKNOWLEDGED THE EXECUTION THEREOF TO BE HIS FREE ACT AND DEED FOR THE USES AND PURPOSES THEREIN EXPRESSED. IN WITNESS WHEREOF I HAVE SET MY HAND AND SEAL ON THE ABOVE DATE.

MY COMMISSION EXPIRES: 7.6.2010
 NOTARY PUBLIC, STATE OF FLORIDA AT LARGE

ACKNOWLEDGMENT: STATE OF FLORIDA, COUNTY OF COLUMBIA.

I HEREBY CERTIFY THAT ON THIS 8th DAY OF August, 2007 A.D., BEFORE ME PERSONALLY APPEARED CHRIS DAMPIER AS SENIOR VICE-PRESIDENT OF PEOPLES STATE BANK, AS MORTGAGEE, TO ME KNOWN TO BE THE PERSON DESCRIBED IN AND WHO EXECUTED THE FORGOING DEDICATION AND ACKNOWLEDGED THE EXECUTION THEREOF TO BE HIS FREE ACT AND DEED FOR THE USES AND PURPOSES THEREIN EXPRESSED. IN WITNESS WHEREOF I HAVE SET MY HAND AND SEAL ON THE ABOVE DATE.

MY COMMISSION EXPIRES: 7.6.2010
 NOTARY PUBLIC, STATE OF FLORIDA AT LARGE

COUNTY ATTORNEY CERTIFICATE:

I HEREBY CERTIFY THAT I HAVE EXAMINED THE FORGOING PLAT AND THAT IT COMPLIES IN FORM WITH THE COLUMBIA COUNTY SUBDIVISION ORDINANCE AND CHAPTER 177 OF THE FLORIDA STATUTES.
 DATE: August 13, 2007
Natalie J. Jorgensen
 COUNTY ATTORNEY

APPROVAL: STATE OF FLORIDA, COUNTY OF COLUMBIA.

THIS PLAT IS HEREBY APPROVED BY THE COLUMBIA COUNTY COMMISSION THIS 2ND DAY OF August, 2007, A.D.

E.W. Porter
 CHAIRMAN

CERTIFICATE OF CLERK OF CIRCUIT COURT:

THIS PLAT HAVING BEEN APPROVED BY THE COLUMBIA COUNTY BOARD OF COUNTY COMMISSIONERS IS ACCEPTED FOR FILE AND RECORDED THIS 9th DAY OF August, 2007, A.D., IN PLAT BOOK 9, PAGE 26-27
P. Dewitt Cason
 CLERK OF COURT, COLUMBIA COUNTY, FLORIDA

SURVEYOR'S NOTES:

- BOUNDARY BASED ON MONUMENTATION FOUND.
- BEARINGS ARE BASED ON AN ASSUMED BEARING OF S.89°41'10"E FOR THE NORTH LINE OF THE SW 1/4 OF THE SE 1/4 OF SECTION 10.
- THIS PARCEL IS IN ZONE "X" AND IS DETERMINED TO BE OUTSIDE THE 500 YEAR FLOOD PLAIN AS PER FLOOD RATE MAP, DATED 6 JANUARY, 1988 COMMUNITY PANEL NUMBER 120070 0175 B. HOWEVER, THE FLOOD INSURANCE RATE MAPS ARE SUBJECT TO CHANGE.
- IF THEY EXIST, NO UNDERGROUND ENCROACHMENTS AND/OR UTILITIES WERE LOCATED FOR THIS SURVEY EXCEPT AS SHOWN HEREON.
- THIS SURVEY WAS COMPLETED WITHOUT THE BENEFIT OF A TITLE COMMITMENT OR A TITLE POLICY.
- EASEMENTS ARE AS SHOWN HEREON.
- THERE MAY BE ADDITIONAL RESTRICTIONS THAT ARE NOT RECORDED ON THIS PLAT THAT MAY BE FOUND IN THE PUBLIC RECORDS OF COLUMBIA COUNTY.
- SURVEY CLOSURE PRECISION EXCEEDS THE REQUIREMENTS OF THE MINIMUM TECHNICAL STANDARDS FOR SURVEYING IN THE STATE OF FLORIDA.
- PRELIMINARY PLAT APPROVED ON JANUARY 5, 2006.

NOTICE:

ALL PLATTED UTILITY EASEMENTS SHALL PROVIDE THAT SUCH EASEMENTS SHALL ALSO BE FOR THE CONSTRUCTION, INSTALLATION, MAINTENANCE, AND OPERATION OF CABLE TELEVISION SERVICES, PROVIDED, HOWEVER, NO SUCH CONSTRUCTION, INSTALLATION, MAINTENANCE, AND OPERATION OF CABLE TELEVISION SERVICES SHALL INTERFERE WITH THE FACILITIES AND SERVICES OF ELECTRIC, TELEPHONE, GAS OR OTHER PUBLIC UTILITY. IN THE EVENT THAT A CABLE TELEVISION COMPANY DAMAGES THE FACILITIES OF A PUBLIC UTILITY, IT SHALL BE SOLELY RESPONSIBLE FOR THE DAMAGES.

SECTIONS 10 & 15, TOWNSHIP 4 SOUTH, RANGE 16 EAST.

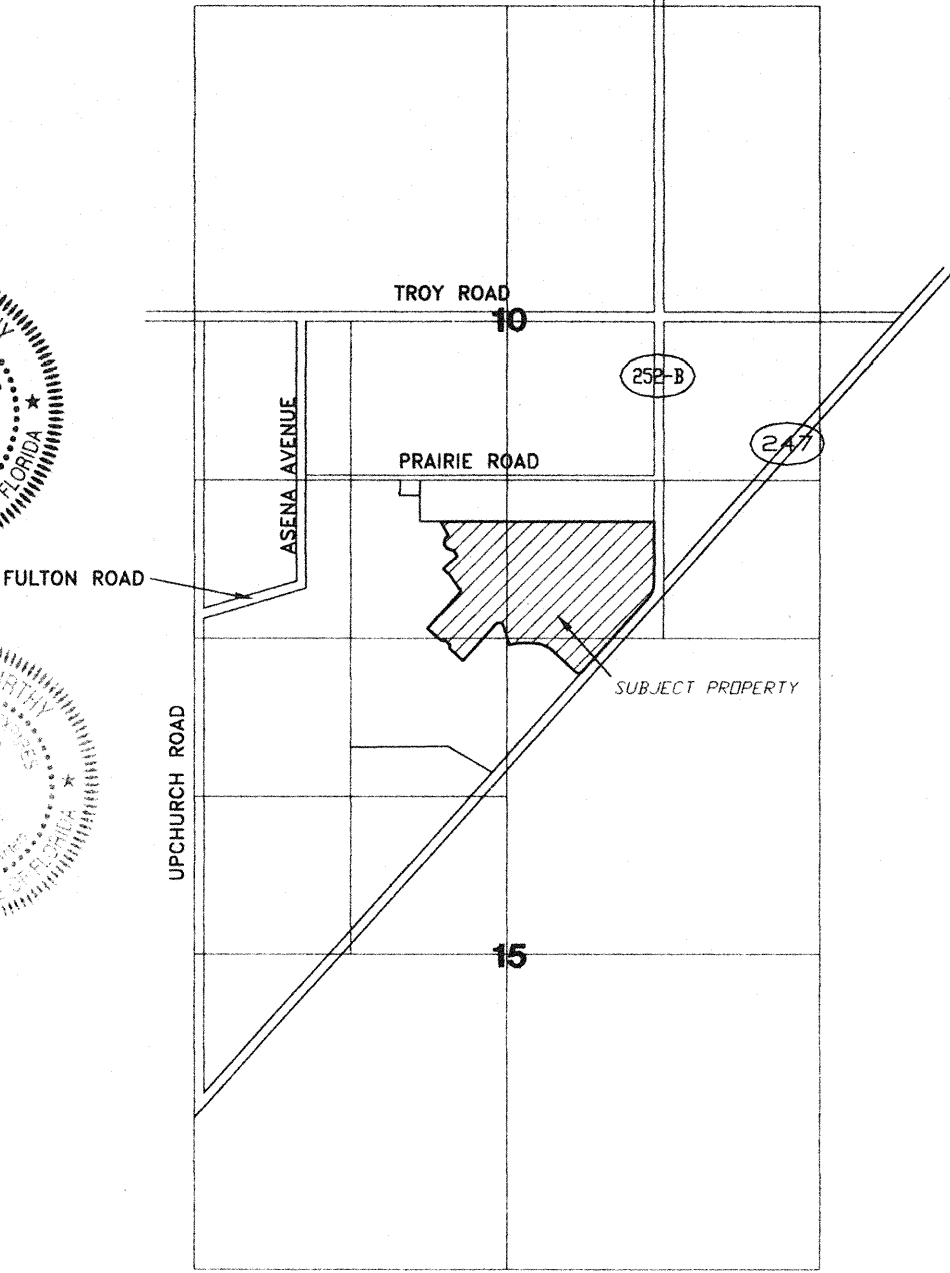

LOCATION SKETCH
 NOT TO SCALE

DESCRIPTION:

COMMENCE AT THE NE CORNER OF THE SE 1/4 OF THE SW 1/4 OF SECTION 10, TOWNSHIP 4 SOUTH, RANGE 16 EAST, AND RUN THENCE S.00°50'24"W, ALONG THE EAST LINE OF SAID SE 1/4 OF THE SW 1/4, 317.12 FEET TO THE POINT OF BEGINNING; THENCE S.89°15'24"E, A DISTANCE OF 1283.01 FEET TO THE WEST RIGHT-OF-WAY OF COUNTY ROAD #252-B; THENCE S.00°56'59"W, ALONG SAID WEST RIGHT-OF-WAY A DISTANCE OF 477.06 FEET TO THE POINT OF CURVATURE OF A CURVE TO THE RIGHT, HAVING A RADIUS OF 2000 FEET, A CENTRAL ANGLE OF 41°56'09", A TANGENT LENGTH OF 76.64 FEET, A CHORD BEARING OF S.21°55'03"W, AND A CHORD LENGTH OF 143.14 FEET; THENCE ALONG THE ARC OF SAID CURVE, AN ARC LENGTH OF 146.38 FEET TO THE POINT OF TANGENCY OF SAID CURVE; THENCE S.42°53'08"W, ALONG THE NORTHERLY RIGHT-OF-WAY OF COUNTY ROAD #247 A DISTANCE OF 779.01 FEET TO THE POINT OF CURVATURE OF A CURVE TO THE RIGHT, HAVING A RADIUS OF 25.00 FEET, A CENTRAL ANGLE OF 90°00'00", A TANGENT LENGTH OF 25.00 FEET, A CHORD BEARING OF S.87°53'08"W, AND A CHORD LENGTH OF 35.36 FEET; THENCE ALONG THE ARC OF SAID CURVE, AN ARC LENGTH OF 39.27 FEET TO THE POINT OF TANGENCY OF SAID CURVE; THENCE N.47°06'52"W, A DISTANCE OF 247.75 FEET TO THE POINT OF CURVATURE OF A CURVE TO THE LEFT, HAVING A RADIUS OF 260.00 FEET, A CENTRAL ANGLE OF 42°36'46", A TANGENT LENGTH OF 101.40 FEET, A CHORD BEARING OF N.68°25'15"W, AND A CHORD LENGTH OF 188.94 FEET; THENCE ALONG THE ARC OF SAID CURVE, AN ARC LENGTH OF 193.37 FEET TO THE POINT OF TANGENCY OF SAID CURVE; THENCE N.89°43'38"W, A DISTANCE OF 91.38 FEET TO THE POINT OF CURVATURE OF A CURVE TO THE LEFT, HAVING A RADIUS OF 260.00 FEET, A CENTRAL ANGLE OF 18°27'07", A TANGENT LENGTH OF 42.23 FEET, A CHORD BEARING OF S.81°02'48"W, AND A CHORD LENGTH OF 83.37 FEET; THENCE ALONG THE ARC OF SAID CURVE, AN ARC LENGTH OF 83.73 FEET TO THE END OF SAID CURVE; THENCE N.18°43'05"W, A DISTANCE OF 183.35 FEET; THENCE S.89°43'38"E, A DISTANCE OF 42.35 FEET; THENCE N.89°43'38"W, A DISTANCE OF 42.35 FEET; THENCE S.42°53'08"W, A DISTANCE OF 400.86 FEET; THENCE N.47°06'52"W, A DISTANCE OF 135.00 FEET TO THE POINT OF CURVATURE OF A CURVE TO THE RIGHT, HAVING A RADIUS OF 25.00 FEET, A CENTRAL ANGLE OF 90°00'00", A TANGENT LENGTH OF 25.00 FEET, A CHORD BEARING OF N.02°06'52"W, A CHORD LENGTH OF 35.36 FEET; THENCE ALONG THE ARC OF SAID CURVE, AN ARC LENGTH OF 39.27 FEET TO THE END OF SAID CURVE; THENCE N.47°06'52"W, A DISTANCE OF 60.00 FEET TO A POINT ON A CURVE TO THE RIGHT, HAVING A RADIUS OF 25.00 FEET, A CENTRAL ANGLE OF 90°00'00", A TANGENT LENGTH OF 25.00 FEET, A CHORD BEARING OF S.87°53'08"W, AND A CHORD LENGTH OF 35.36 FEET; THENCE ALONG THE ARC OF SAID CURVE, AN ARC LENGTH OF 39.27 FEET TO THE POINT OF TANGENCY OF SAID CURVE; THENCE N.47°06'52"W, A DISTANCE OF 135.00 FEET; THENCE N.42°53'08"E, A DISTANCE OF 393.93 FEET; THENCE N.34°53'21"W, A DISTANCE OF 163.71 FEET; THENCE N.47°06'52"W, A DISTANCE OF 60.00 FEET TO A POINT ON A CURVE TO THE RIGHT, HAVING A RADIUS OF 560.00 FEET, A CENTRAL ANGLE OF 12°44'58", A TANGENT LENGTH OF 62.56 FEET, A CHORD BEARING OF N.49°15'37"E, AND A CHORD LENGTH OF 124.35 FEET; THENCE ALONG THE ARC OF SAID CURVE, AN ARC LENGTH OF 124.61 FEET TO THE POINT OF REVERSE CURVATURE OF A CURVE TO THE LEFT, HAVING A RADIUS OF 25.00 FEET, A CENTRAL ANGLE OF 84°36'19", A TANGENT LENGTH OF 22.75 FEET, A CHORD BEARING OF N.13°19'56"E, AND A CHORD LENGTH OF 33.65 FEET; THENCE ALONG THE ARC OF SAID CURVE, AN ARC LENGTH OF 36.92 FEET TO THE POINT OF REVERSE CURVATURE OF A CURVE TO THE RIGHT, HAVING A RADIUS OF 260.00 FEET, A CENTRAL ANGLE OF 05°12'04", A TANGENT LENGTH OF 11.81 FEET, A CHORD BEARING OF N.26°22'11"W, AND A CHORD LENGTH OF 23.59 FEET; THENCE ALONG THE ARC OF SAID CURVE, AN ARC LENGTH OF 23.60 FEET TO THE POINT OF REVERSE CURVATURE OF A CURVE TO THE LEFT, HAVING A RADIUS OF 25.00 FEET, A CENTRAL ANGLE OF 64°30'39", A TANGENT LENGTH OF 15.78 FEET, A CHORD BEARING OF N.56°01'28"W, AND A CHORD LENGTH OF 26.68 FEET; THENCE ALONG THE ARC OF SAID CURVE, AN ARC LENGTH OF 28.15 FEET TO THE POINT OF REVERSE CURVATURE OF A CURVE TO THE RIGHT, HAVING A RADIUS OF 60.00 FEET, A CENTRAL ANGLE OF 150°21'06", A TANGENT LENGTH OF 226.70 FEET, A CHORD BEARING OF N.13°06'15"W, AND A CHORD LENGTH OF 116.01 FEET; THENCE ALONG THE ARC OF SAID CURVE, AN ARC LENGTH OF 157.45 FEET TO THE END OF SAID CURVE; THENCE N.27°55'41"W, A DISTANCE OF 127.79 FEET; THENCE S.89°15'24"E, A DISTANCE OF 413.63 FEET TO THE POINT OF BEGINNING.
 PARCEL CONTAINS 36.01 ACRES, MORE OR LESS.

APPROVAL: PUBLIC WORKS DEPARTMENT, STATE OF FLORIDA, COUNTY OF COLUMBIA.

I HEREBY CERTIFY THAT THE IMPROVEMENTS HAVE BEEN CONSTRUCTED IN AN ACCEPTABLE MANNER AND IN ACCORDANCE WITH COUNTY SPECIFICATIONS AND THAT A MAINTENANCE AND REPAIR SURETY OR CASH BOND IN THE AMOUNT OF \$46,650 OR THAT A PERFORMANCE BOND OR INSTRUMENT IN THE AMOUNT OF \$46,650 HAS BEEN POSTED TO ASSURE COMPLETION OF ALL REQUIRED IMPROVEMENTS IN CASE OF DEFAULT.

Hoyle Crowder 8/14/2007
 DIRECTOR OF PUBLIC WORKS DATE

CERTIFICATE OF COUNTY SURVEYOR:
 KNOWN ALL MEN BY THESE PRESENT, THAT THE UNDERSIGNED, BEING A LICENSED AND REGISTERED LAND SURVEYOR, AS PROVIDED UNDER CHAPTER 472, FLORIDA STATUTES AND IS IN GOOD STANDING WITH THE BOARD OF LAND SURVEYORS, DOES HEREBY CERTIFY ON BEHALF OF COLUMBIA COUNTY, FLORIDA ON THE DATE BELOW I HAVE REVIEWED THIS PLAT FOR CONFORMITY TO CHAPTER 177 FLORIDA STATUTES; AND SAID PLAT MEETS ALL THE REQUIREMENTS OF CHAPTER 177 AS AMENDED.

NAME: *Timothy A. DeLbene* DATE: 8/1/07 REGISTRATION # 5594
 PRINT: **Timothy A. DeLbene**

SURVEYOR'S CERTIFICATE:

I HEREBY CERTIFY THIS TO BE A TRUE AND CORRECT REPRESENTATION OF THE LAND SURVEYED AND SHOWN HEREON, THAT THE SURVEY WAS MADE UNDER MY RESPONSIBLE SUPERVISION, DIRECTION AND CONTROL, THAT PERMANENT REFERENCE MONUMENTS HAVE BEEN SET AS SHOWN AND THAT SURVEY DATA COMPLIES WITH THE COLUMBIA COUNTY SUBDIVISION ORDINANCE AND CHAPTER 177 OF THE FLORIDA STATUTES.
L. Scott Britt 8/1/07
 L. SCOTT BRITT, PSM #5757 DATE

OFFICIAL RECORDS
 BOOK 1128 PAGE 2422

FILE NUMBER 20071201909
 FILED AND RECORDED IN THE OFFICIAL RECORDS OF COLUMBIA COUNTY, FLORIDA
 8-21-07 AT 4:25 O'CLOCK P.M.
 RECORD VERIFIED
 P. DEWITT CASON
 CLERK OF COURTS
 COLUMBIA COUNTY, FLORIDA
 D.C.

PROJECT ENGINEER:
 CURTIS KEEN
 9263 COUNTY ROAD 417
 LIVE OAK, FLORIDA 32060
 1-386-362-4787

DEVELOPER:
 RML HOLDINGS, INC.
 2281 WEST US 90
 LAKE CITY, FLORIDA 32055
 386-755-2309
 PRESIDENT: ROBERT LARDIZABAL

BRITT SURVEYING
 LAND SURVEYORS AND MAPPERS

1426 WEST DUVAL STREET
 LAKE CITY, FLORIDA 32055

TELEPHONE: (386) 752-7163 FAX: (386) 752-5573 WORK ORDER # L-16100

TIMBERLANDS
Phase 1
FOR 2008

PARENT PARCEL – 10-4S-16-02856-000 – 61.70 AC. – 36.00 AC. = 25.70 AC. LEFT

PARENT PARCEL – 15-4S-16-02990-000 – 72.75 AC. – 1.50 AC. = 71.25 AC. LEFT

HEADER PARCEL – 10-4S-16-02856-100 – A S/D LYING IN THE SW1/4 OF THE SE1/4 AND THE E1/2 OF THE SE1/4 OF THE SW1/4 OF SEC 10-4S-16 CONTAINING 36.00 AC. M.O.L. RECORDED ON 8/21/07 IN PLAT BOOK 9 PAGES 26 & 27.

LOT 1	10-4S-16-02856-101	.50 AC.
LOT 2	10-4S-16-02856-102	.50 AC.
LOT 3	10-4S-16-02856-103	.50 AC.
LOT 4	10-4S-16-02856-104	.50 AC.
LOT 5	10-4S-16-02856-105	.50 AC.
LOT 6	10-4S-16-02856-106	.50 AC.
LOT 7	10-4S-16-02856-107	.50 AC.
LOT 8	10-4S-16-02856-108	.50 AC.
LOT 9	10-4S-16-02856-109	.50 AC.
LOT 10	10-4S-16-02856-110	.50 AC.
LOT 11	10-4S-16-02856-111	.50 AC.
LOT 12	10-4S-16-02856-112	.50 AC.
LOT 13	10-4S-16-02856-113	.51 AC.
LOT 14	10-4S-16-02856-114	.56 AC.
LOT 15	10-4S-16-02856-115	.50 AC.
LOT 16	10-4S-16-02856-116	.50 AC.
LOT 17	10-4S-16-02856-117	.50 AC.
LOT 18	10-4S-16-02856-118	.50 AC.
LOT 19	10-4S-16-02856-119	.50 AC.
LOT 20	10-4S-16-02856-120	.50 AC.
LOT 21	10-4S-16-02856-121	.50 AC.
LOT 22	10-4S-16-02856-122	.50 AC.
LOT 23	10-4S-16-02856-123	.50 AC.
LOT 24	10-4S-16-02856-124	.63 AC.
LOT 25	10-4S-16-02856-125	.51 AC.
LOT 26	10-4S-16-02856-126	.51 AC.
LOT 27	10-4S-16-02856-127	.50 AC.
LOT 28	10-4S-16-02856-128	.50 AC.
LOT 29	10-4S-16-02856-129	.50 AC.
LOT 30	10-4S-16-02856-130	.50 AC.
LOT 31	10-4S-16-02856-131	.50 AC.
LOT 32	10-4S-16-02856-132	.50 AC.
LOT 33	10-4S-16-02856-133	.50 AC.
LOT 34	10-4S-16-02856-134	.50 AC.
LOT 35	10-4S-16-02856-135	.50 AC.
LOT 36	10-4S-16-02856-136	.50 AC.
LOT 37	10-4S-16-02856-137	.50 AC.
LOT 38	10-4S-16-02856-138	.50 AC.
LOT 39	10-4S-16-02856-139	.50 AC.
LOT 40	10-4S-16-02856-140	.50 AC.
LOT 41	10-4S-16-02856-141	.50 AC.

RETENTION AREA – 10-4S-16-02856-099 10 AC.

